



# YUMACOLLECTION™

STYLE. COMFORT. FUNCTION.

Yuma Collection™ by Kintec Solution, specifically designed for contemporary furniture designers wanting to broaden the market to a new audience. Yuma is available in manual, power (1 or 2 motors), lifter, glider and sofa applications. Enjoy the near zero-gravity resting position in full recline, courtesy of the low seat and high leg rest positions. The Yuma can support and lift 130 kg (286 lbs.) effortlessly.

## Key Features & Benefits

<b>Available in</b>	Manual recliner, Power recliner, Lifter and Glider (with footstool).
<b>Weight capacity</b>	130 kg. (286 lbs.).
<b>Back recline</b>	100 - 115-degree.
<b>Function</b>	Manual and power (1 or 2 motors).
<b>Base</b>	Pedestal base with swivel column or arms-to-the-floor.
<b>Assembly</b>	Modular system.
<b>Operation</b>	2 - 4 button switches.

### Yuma recliner collection unique features:

- 334 mm (13.14") low-seat height (112.5 mm / 4.42" swivel), up to 404 mm (15.90") high-seat height (182.5 mm / 7.18" swivel).
- 380 mm (14.90") leg rest height with low-seat, up to 450 mm (17.71") leg rest height with the maximum high-seat.
- 75 & 100 kg. (165 - 220 lbs.) backrest weight capacity options.
- Straight or conical seat widths.
- Scissor system leg rest configuration.
- 25,000 lifecycle tested.
- Fast-engaging and smooth response.

## Additional Accessories

<b>Headrests</b>	Compatible with all Kintec headrest style options.	<b>Armrests</b>	Fixed or adjustable armrests for chairs and sofa styles.
<b>Base</b>	Available in all Kintec swivel base style options and height adjustable swivel column, with or without swivel stop.	<b>Power supply</b>	Transformer, battery pack.
		<b>Controls</b>	2 - 4 switches with USB ports or DC charging plug.

# YUMACOLLECTION™



**KINTEC-SOLUTION**  
technic to relax  
A *Leggett & Platt* COMPANY



Place your order by contacting us on:  
**+49 5244 9079 50**  
[order.Kintec@Leggett.com](mailto:order.Kintec@Leggett.com)

## YUMA MANUAL OR POWER (1 OR 2 MOTOR)



## YUMA LIFTER



## YUMA GLIDER



## YUMA SOFA



# YUMACOLLECTION™

Customise your Yuma design.

### Seat frame



Straight (G) 470 x 470 x 500mm  
[Front Width x Back Width x Length]



Conical (K) 470 x 520 x 500mm



Conical small (KS) 420 x 470 x 500mm

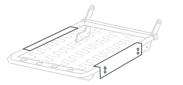

L-shape Bracket  
[Armrest mounting, power only]

**Sofa seat frame** Sofa frames for arms-to-the-floor and mid-leg designs are available in 600, 700 and 800mm widths.

### Headrest

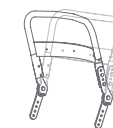

A

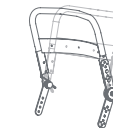

B



C

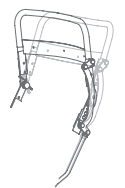

D

**A** Standard friction hinge, compatible with back frame options A & B.

**B** Step friction hinge, compatible with back frame options A & B.

**C** Flexible hinge joint with 180° movement, compatible with back frame options A & B.

**D** Power headrest, compatible with back frame option C.

### Backrest frame



A



B



C

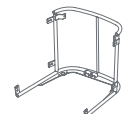

D

**A** Standard straight backrest frame (75 kg | 165 lb. weight capacity).

**B** Extra support backrest frame with mounting plates for outer frame (100 kg | 220 lb. weight capacity).

**C** Extra support backrest frame with power headrest (100 kg | 220 lb. weight capacity).

**D** Frame-in-a-frame design, compatible with options B & C.

### Crossbar

With or without armrest adapters for manual or power mechanisms.

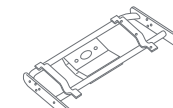

Manual

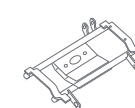

Power

### Pedestal base

More options available, refer to pedestal base brochure.



Lentil base



5 star flat base

### Pedestal column

Available in chrome or black powder coated finish. Multiple colour finishes available depending on quantity orders.



### Power source

Universal transformers to work worldwide.



Mains plug



Battery pack

### Controls



Manual Operation

Ring pull, Lever or push button gas spring release.

[Available in stainless steel, polished or black powder coated]



1, 2 & 3 Motor Slim Switches

Buttons only, DC charging plug or USB port. 2 motor slim switch includes reset button.



1 & 2 Motor NEO Switches

Buttons only or with DC charging plug.